

INTEGRATED COOLING

***COMPRESSOR UNITS FOR AEROMASTER XP
AND AEROMASTER CIRRUS***

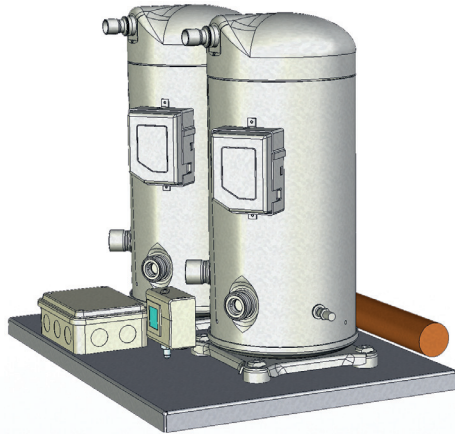



■ Double-compressor design

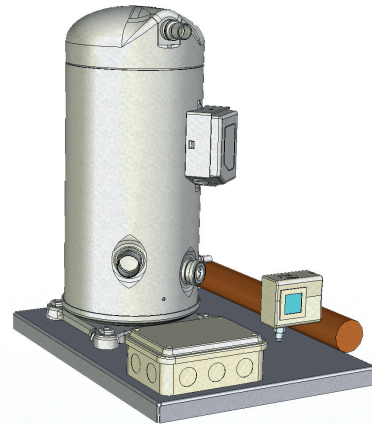

■ Single-compressor design

INTEGRATED COOLING

Compressor units along with optimized Remak exchangers serve as sources of cold for AeroMaster Cirrus and AeroMaster XP air-handling units.

CONFIGURATION

We can deliver either a fully operational unit with all the components (compressors, exchangers, etc.) of the compressor circuit interconnected and the piping filled with coolant so all you need to do is to switch the unit on, or a disassembled unit.

The unit assembly includes the necessary safety and control elements, separate distribution board and suitably dimensioned optional injection valves. Depending on the output, respectively on the requirement of the control level, the unit can be fitted with one or two compressors.

When designing the system, we only use quality components from approved suppliers.

CONTROL

- The unit's output can be controlled on several levels depending on its application.
- The unit's output is controlled by switching the compressor using an external signal, i.e. ON/OFF system. If a double-compressor arrangement is used, 0/50/100 % output control can be achieved by switching the compressors in sequence.
- If an electronic controller is used, the switching of the compressors is then controlled depending on the number of operating hours elapsed.
- If the Digital Scroll™ compressor is used, the refrigerating capacity will then be controlled within a given range steplessly.
- To avoid the whole system's efficiency being reduced, REMAK compressor units are antifreeze protected.

INTEGRATED COOLING ADVANTAGES

- Simplifies and makes air-handling unit commissioning cheaper
- Saves room (no need for installation of outdoor sources of cold)
- Saves operating costs, among others by creating suitable conditions for heat removal (high EER factor – energy efficiency factor)
- Simple, fast and cheap servicing (just one device)
- Minimum length of distribution pipes – minimum volume of coolant
- Low sound level transmitted to the surroundings
- Minimised damage in the event of failure (just one of the sources of cold is disabled)

INTEGRATED COOLING

REMAK SOLUTION ADVANTAGES

- customised solution without catalogue compromises
- option of economy or comfort solution
- simple and therefore failure-free design
- High efficiency due to:
 - minimised effective area of the exchangers
 - selection of suitable components in the circuit (injection valves, etc.)
 - system designed for optimum operating temperatures
- optional delivery of a „plug and play“ unit or a disassembled unit

CIRCUIT CONNECTION DIAGRAM

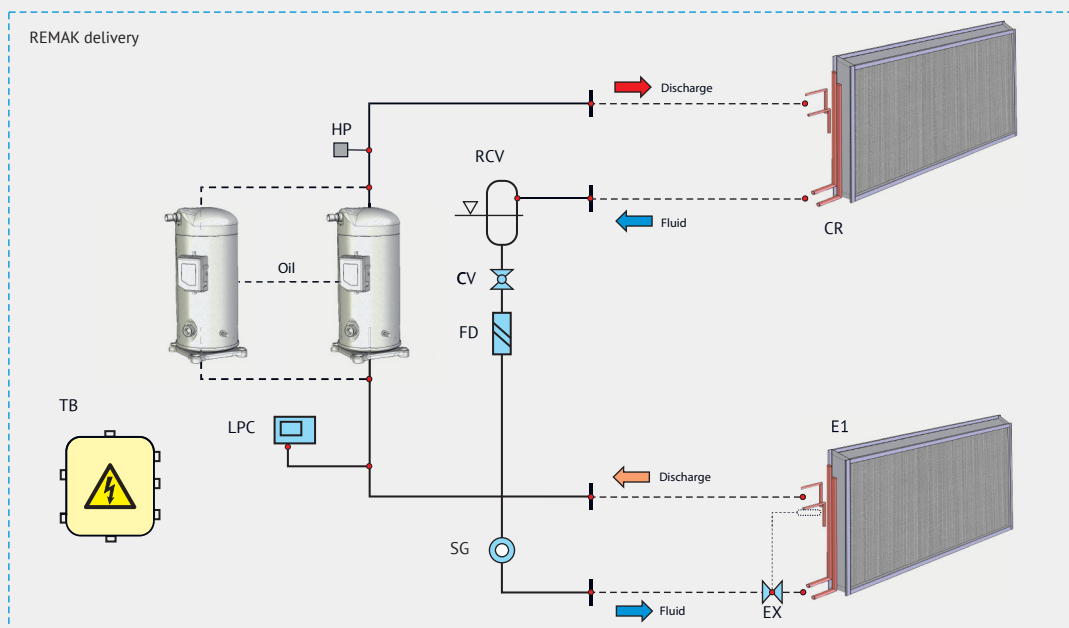

Legend:

- C1, 2 – Compressor(s)
- CR – Condenser
- RCV – Coolant header
- FD – Filter-dehydrator
- CV – shut-off service valve
- SG – Sight glass
- EX – Expansion valve
- E1 – Evaporator
- LPC – Low-pressure pressostat
- HP – High-pressure pressostat
- TB – Unit terminal box
- RKJ – Unit power and control distribution board

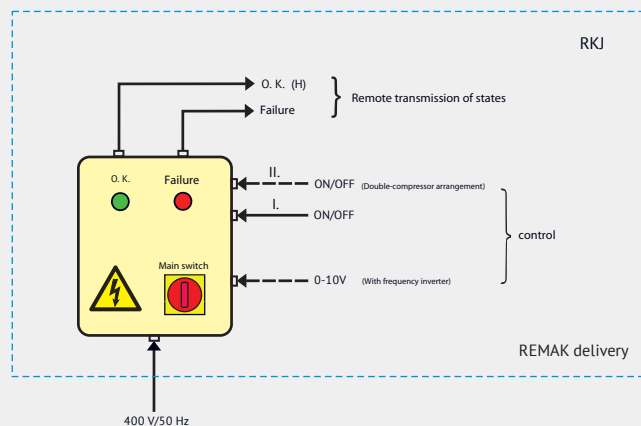

INTEGRATED COOLING

KHX-S1 COMPRESSOR UNITS											
Model	Refrigerating capacity kW, R407C, T _c =+45 °C				Unit dimensions	Weight	Noisiness	Voltage	Operating current	Distribution board	
	Evaporating temperature T _e						Lp			Dimensions	Weight
	+6°C	+9°C	+12 °C	+15 °C	H×W×D (mm)	kg*	dB(A)/10m	V/50Hz	max A	H×W×D (mm)	kg
KHX-S1-4	4,2	4,7	5,3	5,9	540×400×415	32	34	230	7,4	407×304×148	5
KHX-S1-5	5,2	5,8	6,5	7,2	540×400×415	34	34	400	3,8	407×304×148	5
KHX-S1-7	6,7	7,5	8,4	9,3	540×400×415	37	34	400	4,7	407×304×148	5
KHX-S1-8	7,9	8,9	10,0	11,1	540×400×436	39	37	400	5,6	407×304×148	5
KHX-S1-9	9,4	10,5	11,8	13,1	540×400×450	40	37	400	6,3	407×304×148	5
KHX-S1-12	11,4	12,9	14,4	16,0	540×400×470	44	37	400	7,6	407×304×148	5
KHX-S1-14	14,8	16,4	18,2	20,2	540×400×490	44	41	400	9,1	407×304×148	5
KHX-S1-17	16,8	18,8	21,0	23,3	540×400×490	52	41	400	10,5	407×304×148	5
KHX-S1-19	19,1	21,4	24,0	26,8	540×400×490	52	41	400	12,8	407×304×148	5
KHX-S1-22	23,4	26,1	29,0	32,2	540×400×525	71	43	400	14,4	407×304×148	5
KHX-S1-25	26,2	29,3	32,7	36,3	540×400×582	73	43	400	15,5	407×304×148	5
KHX-S1-29	30,6	34,2	38,2	42,4	540×400×582	75	43	400	18,2	407×304×148	5
KHX-S1-33	35,1	39,3	43,8	48,6	540×400×582	87	44	400	20,1	500×400×240	17
KHX-S1-36	38,5	43,6	49,0	55,0	540×400×601	91	47	400	23,1	500×400×240	17
KHX-S1-43	44,8	50,2	56,0	62,2	690×400×601	97	49	400	29,2	500×400×240	19
KHX-S2 COMPRESSOR UNITS											
KHX-S2-38	38,2	42,8	48,0	53,6	690×500×494	106	44	400	25	500×400×240	19
KHX-S2-44	46,8	52,2	58,0	64,4	690×500×525	147	46	400	28,4	500×400×240	19
KHX-S2-50	52,4	58,6	65,4	72,6	690×500×582	152	46	400	30,8	500×400×240	19
KHX-S2-58	61,2	68,4	76,4	84,8	690×500×582	156	46	400	36,1	600×400×240	20
KHX-S2-66	70,2	78,6	87,6	97,2	690×500×582	156	47	400	40,3	600×400×240	20
KHX-S2-73	77,0	87,2	98,0	110,0	690×500×601	164	50	400	45,6	600×400×240	20
KHX-S2-87	89,6	100,4	112,0	124,4	690×500×601	169	52	400	58,2	700×500×280	23

* The weight includes the distribution board; applies for calculation of the units in ON/OFF version.



SOLUTION FOR A BETTER ENVIRONMENT

REMAK a.s.

Zuberská 2601, 756 61 Rožnov pod Radhoštěm

tel.: +420 571 877 778, fax: +420 571 877 777

www.remak.eu



Your Dealer: